

### Building Sketch (Page - 1)

Client	Broker and Company Name Here			
Property Address	123 Your St			
City	Winston-Salem	County	Forsyth	State NC Zip Code 27103
Owner	Property Owner's Name Here			

Information is Subject to Verification and Not Guaranteed.

Exterior measurements are to the nearest 10th of a foot. Interior measurements are to the nearest inch.  
 Floor plans are for informational purposes and are not intended for construction or renovation purposes.

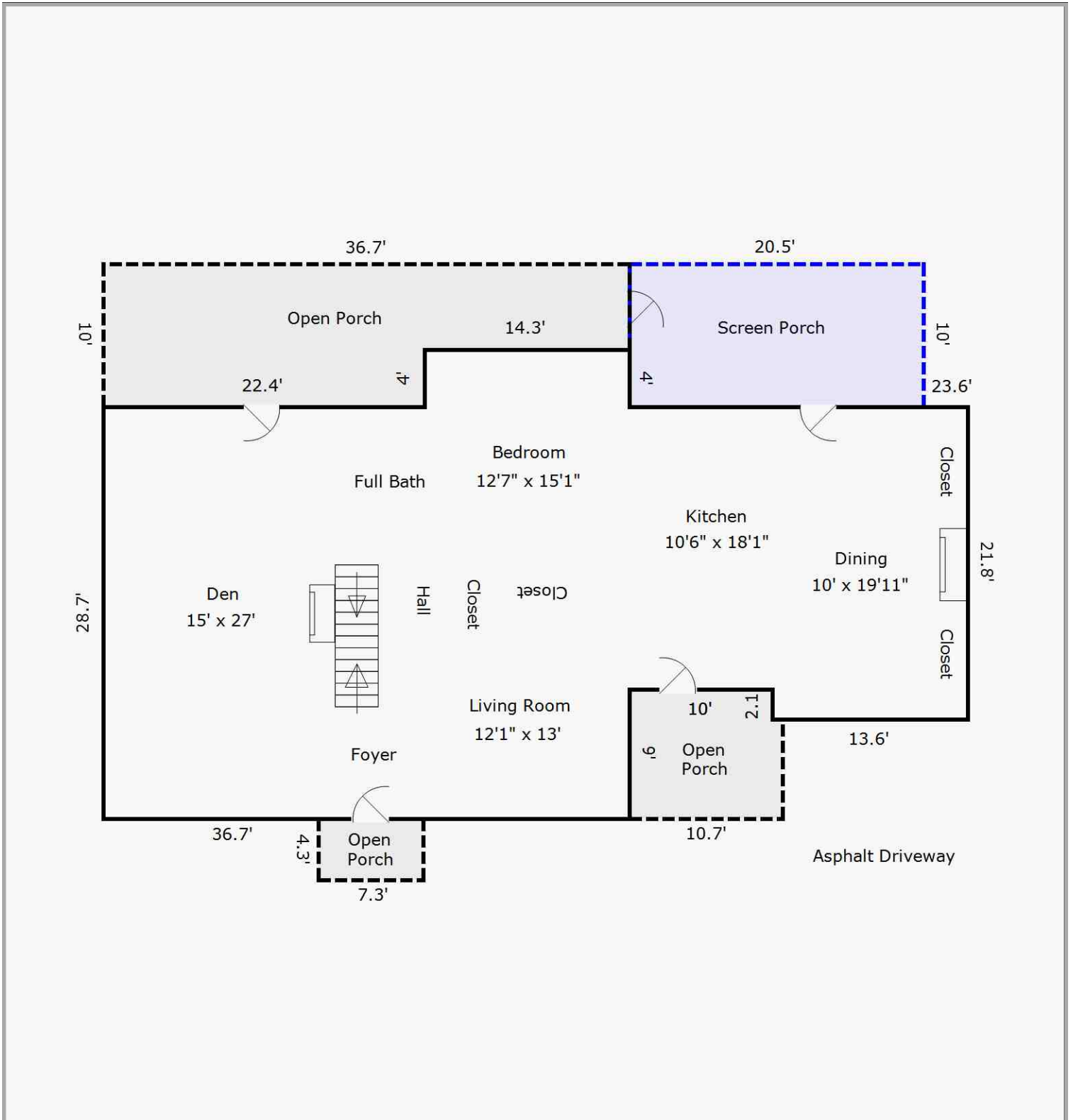

TOTAL Sketch by a la mode, inc.

#### Area Calculations Summary

Living Area	Calculation Details	
First Floor	1603.97 Sq ft	$14.3 \times 4 = 57.2$ $28.7 \times 36.7 = 1053.29$ $23.6 \times 19.7 = 464.92$ $2.1 \times 13.6 = 28.56$
<b>Total Living Area (Rounded):</b>	<b>1604 Sq ft</b>	
<b>Non-living Area</b>		
Open Porch	94.83 Sq ft	$9 \times 10 = 90$ $6.9 \times 0.7 = 4.83$
Screen Porch	205 Sq ft	$10 \times 20.5 = 205$
Open Porch	31.39 Sq ft	$7.3 \times 4.3 = 31.39$
Open Porch	309.8 Sq ft	$10 \times 22.4 = 224$ $14.3 \times 6 = 85.8$

### Building Sketch (Page - 2)

Client	Broker and Company Name Here			
Property Address	123 Your St			
City	Winston-Salem	County Forsyth	State NC	Zip Code 27103
Owner	Property Owner's Name Here			

Information is Subject to Verification and Not Guaranteed.  
 Exterior measurements are to the nearest 10th of a foot. Interior measurements are to the nearest inch.  
 Floor plans are for informational purposes and are not intended for construction or renovation purposes.

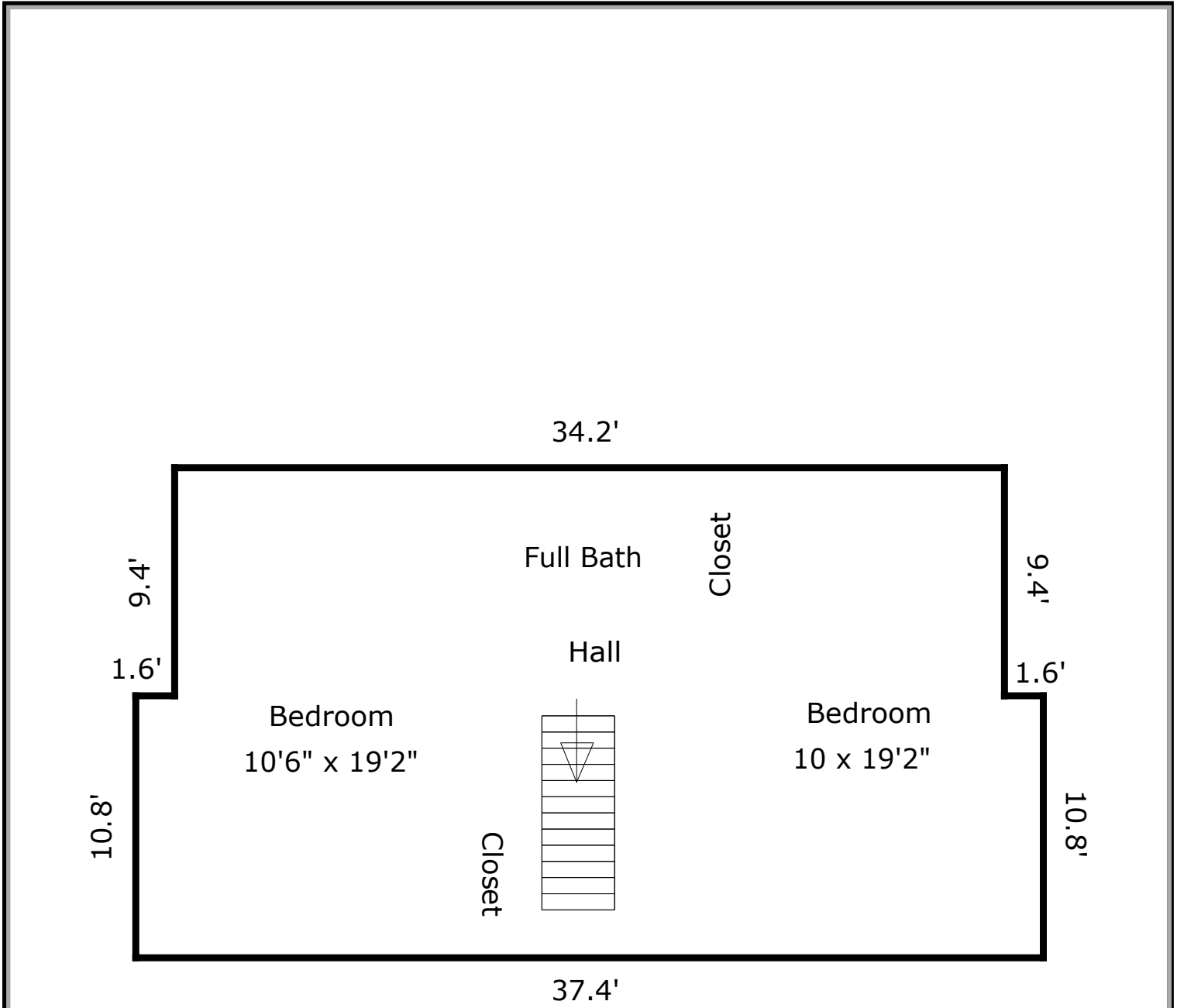

TOTAL Sketch by a la mode, inc.

#### Area Calculations Summary

Living Area	Calculation Details	
Second Floor	725.4 Sq ft	37.4 × 10.8 = 403.92 9.4 × 34.2 = 321.48
<b>Total Living Area (Rounded):</b>	<b>725 Sq ft</b>	

### Building Sketch (Page - 3)

Client	Broker and Company Name Here			
Property Address	123 Your St			
City	Winston-Salem	County Forsyth	State NC	Zip Code 27103
Owner	Property Owner's Name Here			

Information is Subject to Verification and Not Guaranteed.  
 Exterior measurements are to the nearest 10th of a foot. Interior measurements are to the nearest inch.  
 Floor plans are for informational purposes and are not intended for construction or renovation purposes.

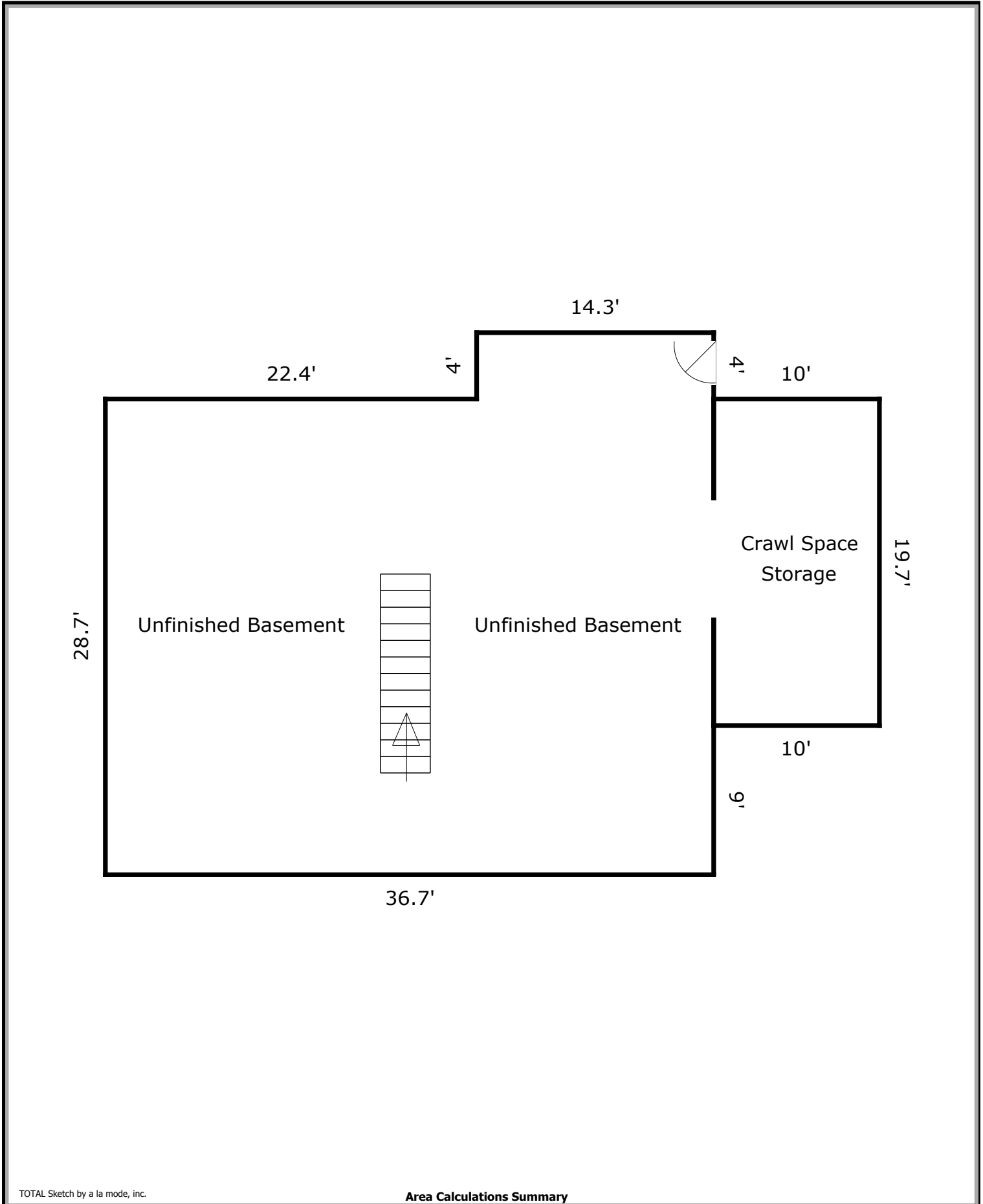

TOTAL Sketch by a la mode, inc.

#### Area Calculations Summary

Non-living Area		
Unfinished Basement	1110.49 Sq ft	36.7 × 28.7 = 1053.29 14.3 × 4 = 57.2
Crawl Space	197 Sq ft	10 × 19.7 = 197